

Wyoming Certified Land Corner Recordation Certificate

This form is to be completed in accordance with W.S. 36-11-101, printed in black ink or typed, and shall be for one individual corner.

Describe below, or show in sketch attached to this form, the corner evidence found. Include condition and type of monument, accessories and ties. Describe any maintenance or rehabilitation performed. In the circle to the right, show monument inscription. If monument is determined lost or obliterated, restate the GLO or BLM original field note record; describe or show the procedure used to reestablish the corner and all data as above for a found monument.

Field Date 3/13/91 Office Reference 2227

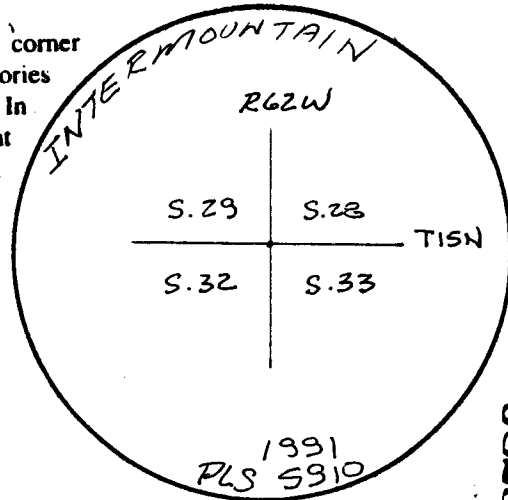

RECEIVED
 LARAMIE COUNTY
 CHEYENNE, WY.
 '91 APR 3 AM 11 03
 082957

EVIDENCE FOUND:

CORNER WAS OBLITERATED.
 CORNER WAS RE ESTABLISHED FROM
 EVIDENCE OBTAINED FROM FENCE LINES,
 STATEMENTS FROM RESIDENTS AND
 VERIFIED WITH BEARINGS & DISTANCES
 TO ADJACENT CORNERS.
 FOUND #4 REBAR SOUTH FENCE CORNER
 - NOT ACCEPTED -

GLO RECORD:

SANDSTONE 20"x10"x4"

MONUMENT SET:

36" ROD, W/3" ALUM. CAP

REFERENCE POINTS SET:

PK/WASHERS PLS 5910

Monument Inscription

LOCATION SKETCH

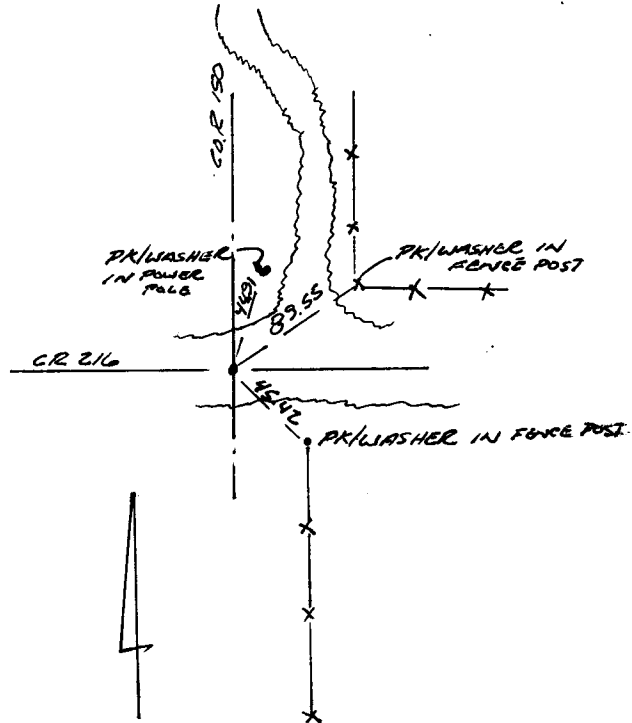

State of Wyoming

Office of County Clerk

County of _____

This Certified Land Corner Recordation Certificate was filed for record on the _____ day of _____, 19 ____, in Book No. T 15N, R 62W, on Alpha-Numeric coordinates V-9 and was noted on the Cross Index Plat.

County Clerk

Corner Type:

Aliquot Corner Other

Corner Name SECTION

Section(s) 29 | 28
32 | 33

Township 15N

Meridian 6TH

Range 62W Page _____

Sheet 1 of 1

